

# se:lab update

Solutions for agile working

# 02

NEW ARRIVALS – May 2023 | 15



### se:lab mobile planter

- Brings cosiness and green areas to every environment
- Planters available in different colours
- Optionally available with separate planters

### se:lab monitor wall

- Designed for the use of flat screens up to 65 inches
- Mobile and flexible for use in different areas
- Optimal technical integration

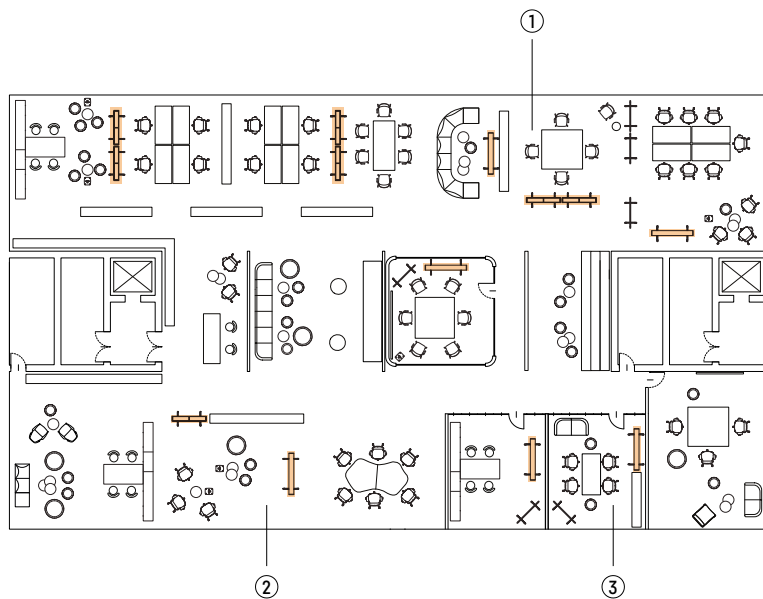

#### Application areas

##### se:lab mobile planter

- Project rooms and workshops (1)
- Hubs and intermediate areas (2)
- Open Space

##### se:lab monitor wall

- Project rooms and workshops (1)
- Hubs and intermediate areas (2)
- Meeting and seminar rooms (3)
- Open Space











**se:lab fabric wall**

- Fabric-covered screen
- Simply pin up a note or poster
- Suitable for use as a zoning element, stackable

**se:lab pin & write**

- Mobile and flexible use, stackable
- One side whiteboard: writable, Post-it-compatible, magnetic
- One side cork: notes easily pinned up
- Suitable for use as a zoning element

**se:lab meet & stand**

- Motorised, height-adjustable meeting table
- Depending on size, for up to 10 people in the sitting area
- Promotes change of posture and more movement

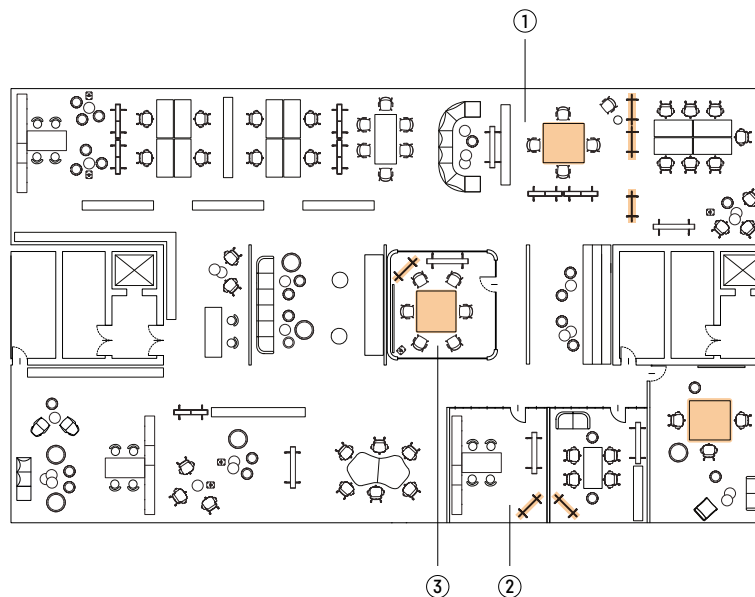
**Application areas****se:lab fabric wall / pin & write**

- Project rooms and workshops (1)
- Hubs and intermediate areas
- Meeting and seminar rooms (2)
- Open Space

**se:lab meet & stand**

- Project rooms and workshops (1)
- Meeting and seminar rooms (2)
- Video conferences (3)





# se:lab mobile planter



## Features (standard)

- Lockable castors
- Removable attachments for the planter tray

## Dimensions

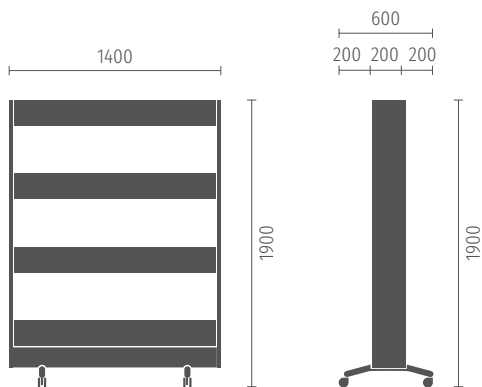

## Colours

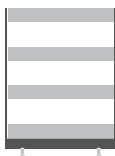

Carcass

The carcass is available from the melamine collections Wood Selection, Architecture Line, Colour Harmony and veneers



Planters & base



Black



Clear white



Fjord green



Cayenne red



Sand beige







# se:lab monitor wall



## Features (standard)

- Lockable castors
- Depending on the size, for monitors up to 65 inches
- 5-metre connection cable

## Options/accessories

- Technical integration with HDMI through-type coupling and/or power and/or USB-A/C
- Back panel as a pinnable fabric element or ready to accommodate a se:lab board (Size M)

## Dimensions

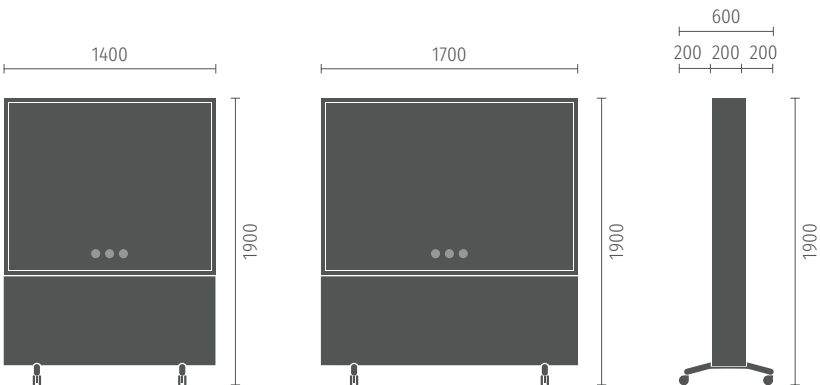

## Colours

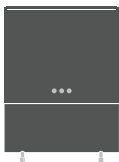

Carcass

The top and the bottom units are available from the melamine collections Wood Selection, Architecture Line, Colour Harmony and veneers (Page 68). The colours for the upper and lower sections can be selected independently of each other.



Base



Black



Clear white



Fjord green



Cayenne red



Sand beige





## se:lab fabric wall



### Features

- Covered with pinnable fabric on both sides
- Lockable castors/stackable in a space-saving way

### Dimensions

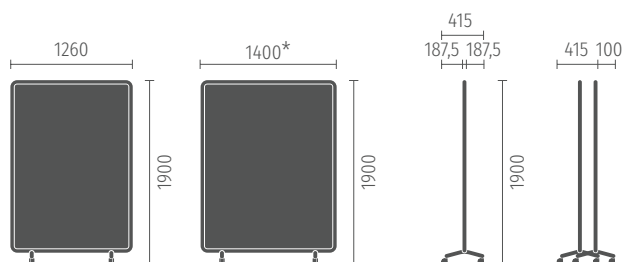

\*W 1400 only for se:lab fabric wall

### Colours



Surface  
Fabric wall

Front and back can be configured independently from each other within one fabric collection and can be selected from the following fabric collections in the Sedus portfolio: Atlantic, Connect, Cura, Era, Fame, Milano, Sophie Screen, Nova, Remix, Step, Step Melange, Tempt.



Surface  
pin & write



Cork



Whiteboard

The se:lab pin & write has two sides: One side is fitted with pinnable cork, the other side with a whiteboard surface.



Frame



Black



Clear white



Fjord green



Cayenne red



Sand beige

## se:lab pin & write



### Features

- Front and back in different designs
- Whiteboard side: writable, magnetic, Post-it compatible
- Cork side: pinnable
- Lockable castors/stackable in a space-saving way

