

se:vision desk and storage

Premium desk with
adjacent storage space





Modern design with a focus on quality and style – se:vision desk and storage combine prestige and individuality.

The purist design of the premium table with optional adjacent storage space impresses with a high degree of design freedom. The result: optimum customisation to suit personal requirements, from purist to homely.

se:vision desk

- High-quality individual desk in a purist design
- Three base frame versions (powdered aluminium, chrome-plated or covered with veneer)
- Precise workmanship to the highest standards
- Wide variety of designs thanks to large selection of colours and materials
- Concealed cable management, e.g. integrated cable routing in the table leg
- Can be used as a free-standing individual desk or in combination with se:vision storage (see below)

se:vision storage

- High-quality storage space close to the workstation
- Can be used as a free-standing sideboard or in combination with se:vision desk (see above)
- Concealed cable management
- Wide variety of designs thanks to large selection of colours and materials: From inviting homeliness to stylish purism

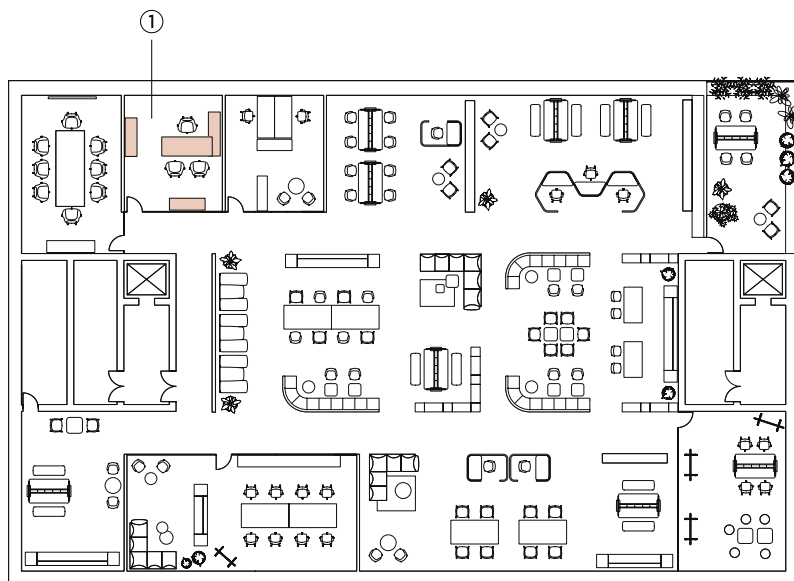

Application area

- Management workstations (1)

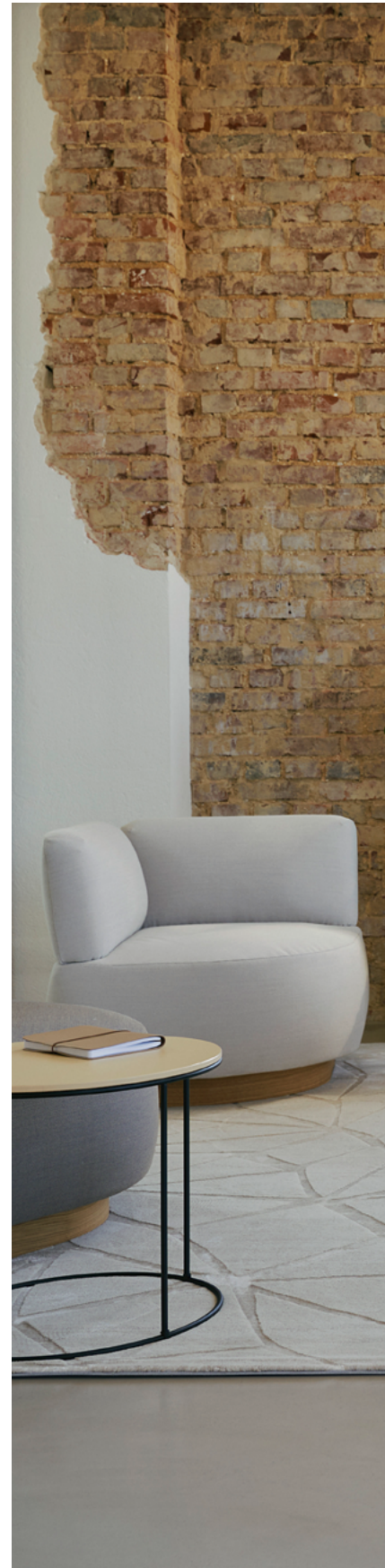





se:vision desk



Features (standard)

- Free-standing table or mounted on se:vision storage
- Table legs: Powdered aluminium, chrome-plated or covered with veneer
- Tabletop: 19- or 25-mm thick
- With angular or rounded table top corners
- Concealed cable routing for power supply through table leg (for all table leg versions)
- With or without bevelled table edge



Standard



Bevelled edge

Options/accessories

- Power supply in the table top
- Continuous, foldable cable tray (available in all powder colours)
- Fixed modesty panel in melamine or veneer

Dimensions and table top shapes (all dimensions in mm)

Free-standing



With storage space

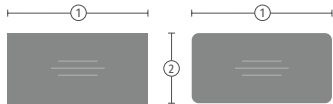

- ① 1600/1800/2000/2200/2400
② 800/1000/1200

Colours

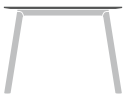

Table top

Finishes: Melamine collections (Wood Selection, Architecture Line), Soft Touch, Fenix, linoleum and veneer.



Table legs wood



Oak (natural)



Walnut (smooth)



Oak (anthracite)



Table legs in aluminium, support beam, cable tray



Black



Clear white



Chrome-plated*



Fjord green



Cayenne red



Sand beige



Deep green



Bronze (dark)

The support beam and cable tray can be selected in any colour, regardless of the base frame. * The colour chrome-plated is only possible for table legs.



Dimensions (all dimensions in mm)

se:vision storage in combination with se:vision desk

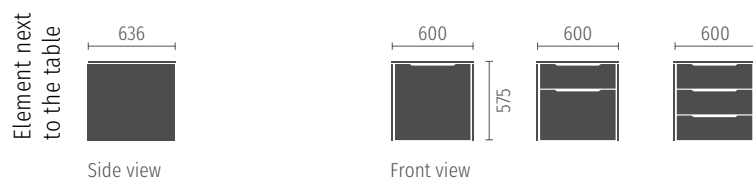
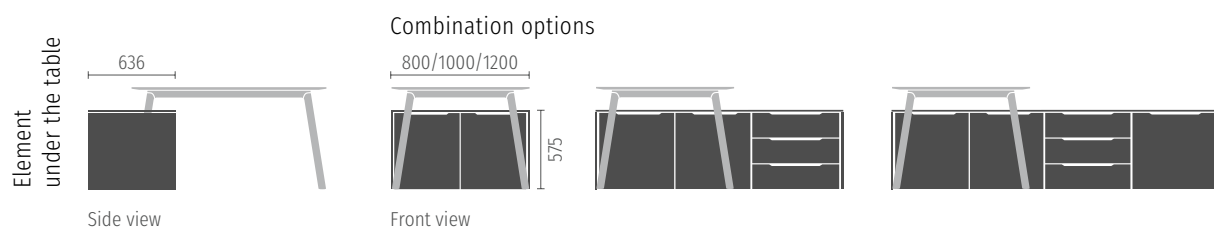

se:vision storage as a free-standing sideboard

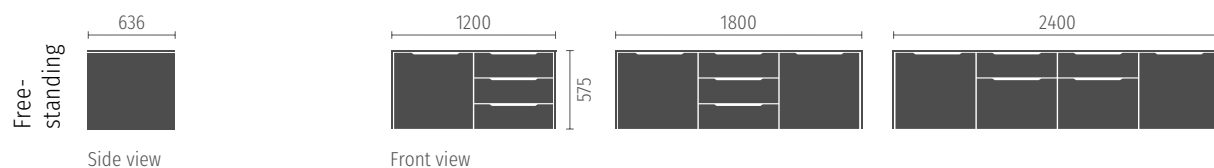

se:vision storage



Features (standard)

- Can be used as a free-standing sideboard or in combination with a top-mounted se:vision desk
- Consisting of inner carcass and various cover panels and side panels (13 mm)
- Fixed height (575 mm) and depth (636 mm)
- Three widths for elements under the table (matching the table depth: 800, 1000, 1200 mm), one width for the element next to the table (600 mm)
- Various front divisions or carcass fittings
- “Push-to-open” or handle bar to open doors and drawers

Options/accessories

- Different surfaces available for fronts, top shelf, sides and back panel
- Lockable drawers or door with exchangeable core or RFID (battery-operated)
- Cable management for power supply of the se:vision desk

Colours



Cover panel,
sides

13-mm finishes: Melamine collections (Wood Selection, Architecture Line, Colour Harmony), Soft Touch, Fenix, linoleum and veneer.



Front,
back panel

19-mm finishes: Melamine collections (Wood Selection, Architecture Line, Colour Harmony), Soft Touch, Fenix and veneer.
The inner carcass is always graphite black melamine.



Handle strip



Black